

# HUNT BOILERS

A division of Forbes (Aust) Pty Ltd

THIS DRAWING WAS PREPARED BY HUNT BOILERS. THE INFORMATION IT CONTAINS IS CONFIDENTIAL AND MUST NOT BE USED, DISCLOSED OR REPRODUCED WITHOUT WRITTEN AUTHORITY.

ALL DIMENSIONS IN MILLIMETRES

DRAFT **P.C.H.**

PART # **VSL400GA**

A4

DO NOT SCALE THIS DRAWING

DATE **18/12/96**

TITLE/PART  
**ALFAREL VSL400 (400 kW) VERTICAL TUBELESS STEAM BOILER**

COMPUTER AIDED DRAFT

PASSED \*\*

No	REVISION	DATE	DRN



### FLUE FLANGE DETAIL

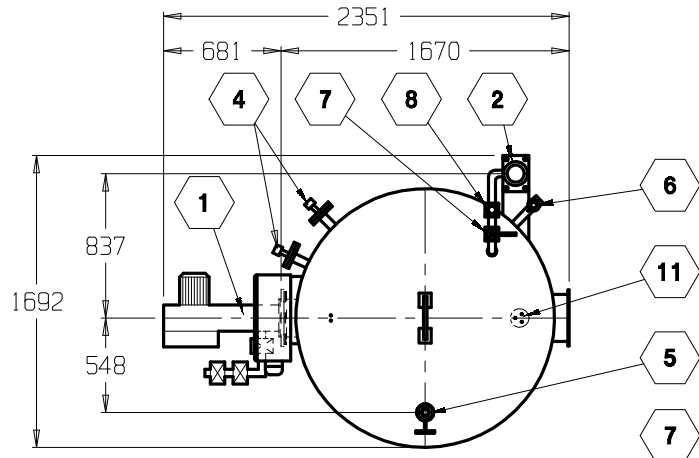
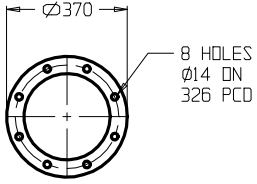

PLAN VIEW

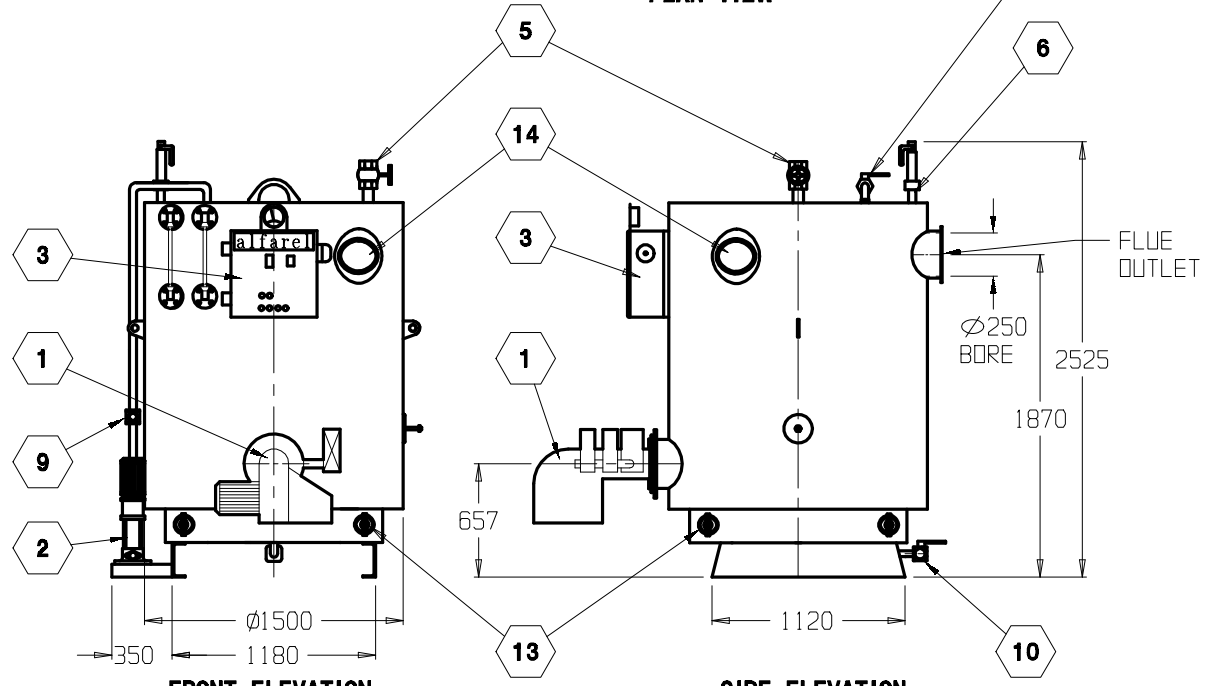

FRONT ELEVATION

SIDE ELEVATION

NOTE: ALL CONNECTIONS FOR SERVICES ARE THREADED BSP

### SPECIFICATIONS:

**VERTICAL TUBELESS STEAM BOILER**  
**MODEL; VS400/700 kPa**  
**KILOWATT RATING; 400**  
**CLASS 2B VESSEL AS1228, TABLE 1.5**

OPERATING PRESSURE; 700 kPa  
 DESIGN PRESSURE; 710 kPa  
 EVAPORATION; 638.8 kg/hr  
 INPUT; 1800 Mj/hr  
 OUTPUT; 1440 Mj/hr  
 DIESEL OIL; 46.3 L/hr  
 L.P.G.; 70.3 L/hr  
 NATURAL GAS; 46.5 M<sup>3</sup>/hr  
 HEATING SURFACE; 11.70 M<sup>2</sup>  
 SHIPPING WEIGHT; 2700 KILOGRAMS  
 FLOODED CAPACITY; 1643 LITRES  
 OPERATING CAPACITY; 1124 LITRES  
 FOOTPRINT AREA; 1680 CM<sup>2</sup>

ITEM	DESCRIPTION	MANUFACTURER	MODEL	SIZE	QTY
14	STEAM SPACE DOOR	HUNT	225 x 180		1
13	WATER SPACE DOOR	HUNT	115 x 90		4
12	PRESSURE GAUGE	DOBBIE	GPO-2500	100	1
11	WATER LEVEL PROBE	HUNT	WLPH0000		3
10	BLOWDOWN VALVE	PEGLER	P.H.310	40NB	1
9	CHECK VALVE VERT	TOYO	FIG 230	25NB	1
8	CHECK VALVE HORZ	JOHNS	FIG 521	25NB	1
7	FEEDWATER VALVE	PINTOSSI	FIG 2010	25NB	1
6	SAFETY VALVE	CONSOLIDATED	FIG 1543	25NB	1
5	MAIN STEAM VALVE	JOHNS	FIG 501	50NB	1
4	GAUGE GLASS MOUNT	KLINGER	AB12	20NB	2
3	CONTROL PANEL	HUNT	EPANEL50		1
2	PUMP	GRUNDFOS	CR2-130	25NB	1
1	BURNER	SAACKE	PA10/PAG10		1