

Design Data:  
 Design Code Reference: AS1228-1997  
 Vessel class: One  
 Rated Output: 4 MW (4000 kW)  
 Design Pressure: 1200 kPa (12 bar)  
 Hydrostatic test pressure: 1800 kPa  
 Transport Mass: 15.2 Tonne  
 Flooded Mass: 20.6 Tonne  
 Top drum OD: 760  
 Bottom drum OD: 610  
 Insulation: 50mm Rockwool

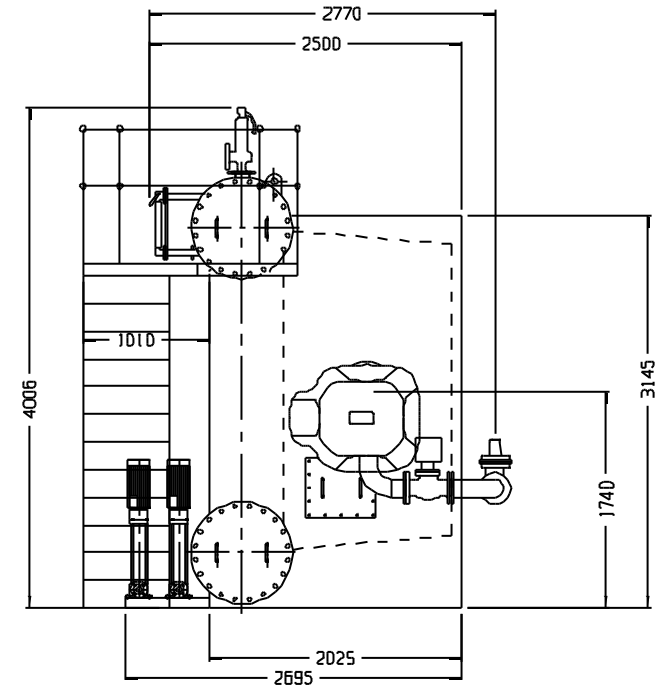

NO	REVISION	DATE	CKD
1	REDRAWN		

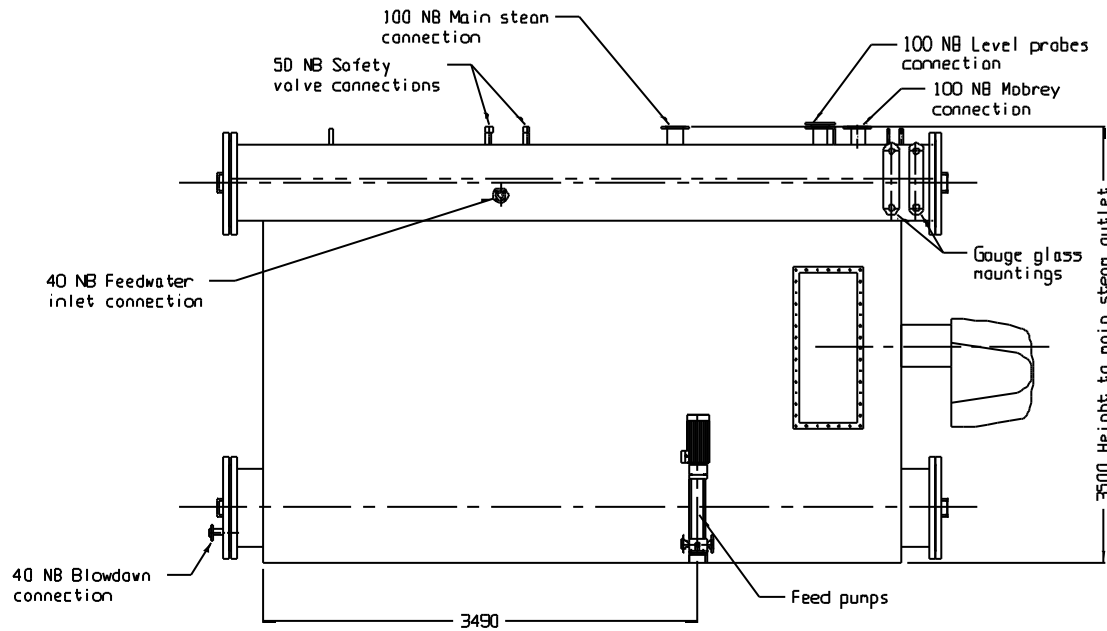
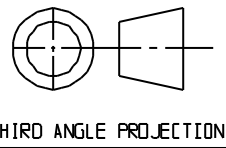

**HUNT**  
**BOILERS**  
 A division of Farbes (Aust) Pty Ltd

THIS DRAWING WAS PREPARED BY HUNT BOILERS. THE INFORMATION IT CONTAINS IS CONFIDENTIAL AND MUST NOT BE USED, DISCLOSED OR REPRODUCED WITHOUT WRITTEN AUTHORITY.

ALL DIMENSIONS IN MILLIMETRES	DRAFT P.C.H.	TITLE/PART
DO NOT SCALE THIS DRAWING	DATE 14/02/03	General arrangement Hunt WT 4MW O-Type Steam Boiler
COMPUTER AIDED DRAFT	PASSED **	PART # WT4MW-GA

File name & path: P:\Boiler Drawings\Hunt WT dwgs\WT 4MW\WT4MW-GA.prt